

GLADEN[®]

GERMAN TECHNOLOGY

User's guide for amplifier

RC 105c4 G2

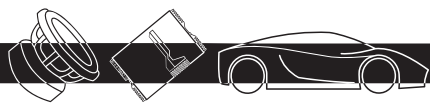

FEATURES

RC 105c4 G2

- 4-channel high power amplifier CLASS AB
- MOS-FET Power Supply
- Stable at 2 ohm stereo per channel and 4 ohm bridge mode
- Variable switchable Low Pass Filter from 45 to 225 Hz (CH 1-4)
- Variable switchable High Pass Filter from 45 to 225 Hz (CH 1-4)
- High Level input with auto sense (auto sense works only on CH1)
- Protection for overheating, overloading, short circuit and speaker DC protection
- Wired Remote-Controller sRTC for CH 3&4 (optional)

Specifications:

Rated output power 1%THD, 14,4V

RMS power 4 Ohm stereo 105W x 4

RMS power, 2 Ohm stereo 150W x 4

RMS power, 4 Ohm bridged 300W x 2

Signal to noise ratio (1W) >80dB

Low Level input sensitivity 0,2-5V

High Level input sensitivity 0,4-10V

Frequency response 10-20.000Hz

Channel separation >50dB

Operating voltage DC 10-16V

Dimensions (mm) L 360 x B 150 x H52



Information on disposal of old electrical and electronic equipment

(Applicable for countries that have adopted separate waste collection systems) Products with the symbol (crossed-out wheeled bin) cannot be disposed of as household waste. Old electrical and electronic equipment should be recycled at a special waste facility. Contact your local authority for details in locating a recycle facility nearest to you. Proper recycling and waste disposal will help conserve resources whilst preventing detrimental effects on our health and the environment. This product can be disposed of with the used car together. In this case don't remove it from the car.

Gladen Europe GmbH
Bertha-Benz-Str.9
D-72141 Walddorfhäslach
www.gladen.com



POWER CONNECTION

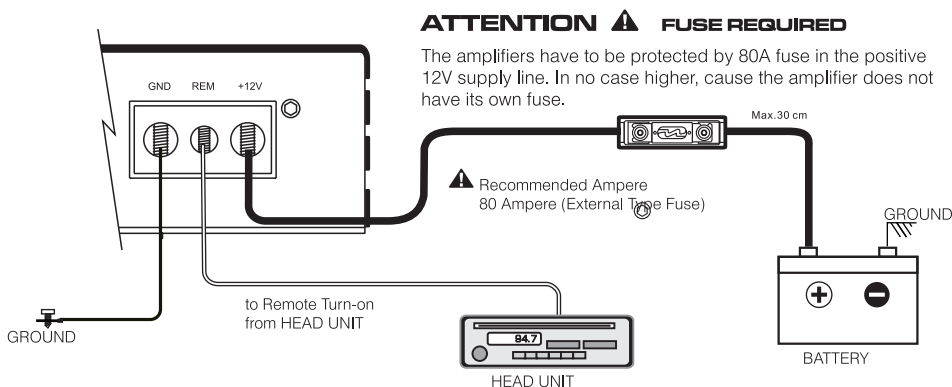

1. Battery disconnection

First, disconnect the power supply of the vehicle by removing the ground of battery.

2. Ground connection

Connect the GND (ground) connection of the amplifier with the car chassis. Keep this cable as short as possible and use a suitable cross section (AWG size 6 - 4). Make sure, that the connection with the vehicle chassis is free of paint, dirt and dust.

3. +12V Power connection

Connect the +12V contact of the amplifier with the supply cable via a fuse directly to the vehicle battery. Keep in mind, that the length of the cable from fuseholder to vehicle battery has to be maximum 30cm.

For the amplifier to function at its best, use a high quality fuse holder and suitable cable preferably AWG 6-4 cable.

This fuse protects the amplifier and the vehicle against the possibility of a short circuit in the power cable.

4. Remote connection

Connect the REM-terminal of the amplifier to the remote output (+12V antenna output) of the head unit. Use a 0,5 - 1,5 mm power cable.

⚠ **Caution** ⚠

Please take the following precautions when installing your amplifier:

- a)** Take extra care when making the connections. Make sure that no electrical cable, gas tank, hydraulic brakes or other components get damaged.
- b)** Allow enough cooling and air circulation and avoid installing the unit in small closed boxes or close to parts that heats up easily.
- c)** Keep the amplifier away from liquid, moisture, heat and foreign materials.
- d)** This amplifier can only be used in vehicles with 12V DC power supply.
- e)** Never install the power supply cable with other original vehicle wires (gas cables), fan motors, control modules etc.
- f)** Install the signal cable (cinch cable) as well as speaker cable far away from the power cables to avoid interference with music signals.
- g)** To avoid dangers of cables binding, squeezing or breaking, use the cables supplied with your amplifier.

RCA CONNECTION

RC 105c4 G2

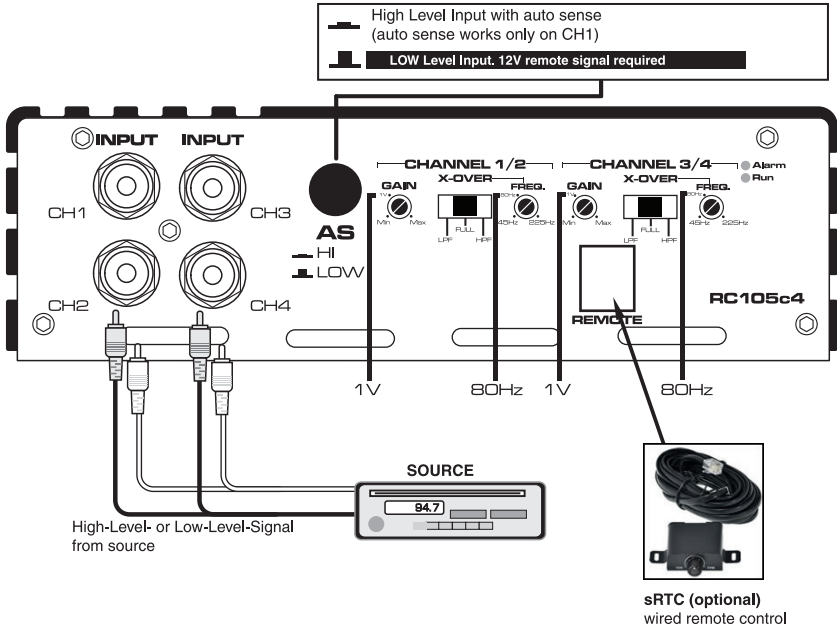

SPEAKER CONNECTION

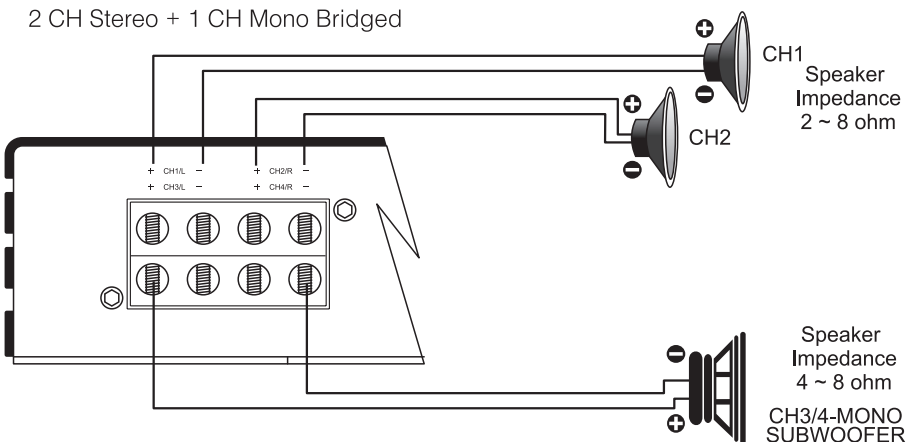
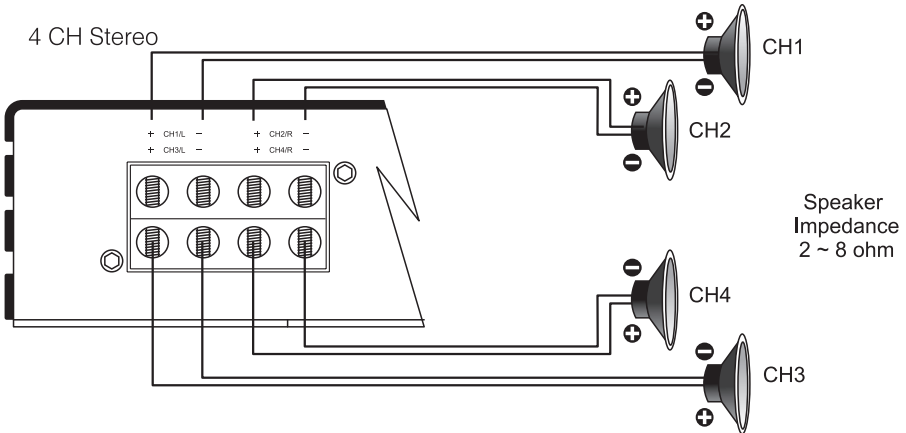
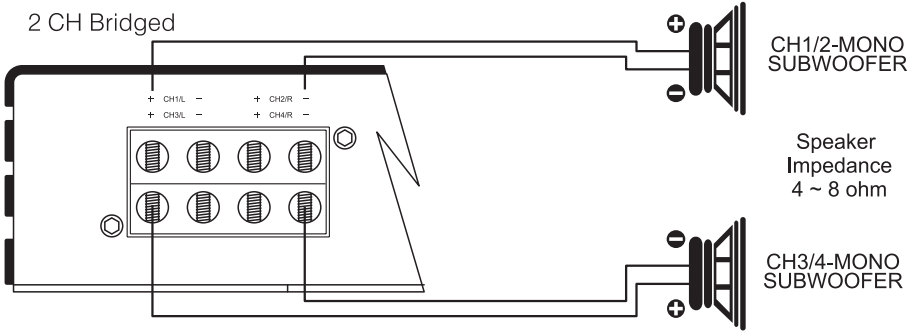

TROUBLESHOOTING

This power amplifier is featured with an efficient protection system to prevent any damages from overheating, overloading, short cuts etc.

The ALARM LED will light up red.

Prior to checking the problem(s), first turn down the volume of the radio and then turn it off.

AMPLIFIER IS NOT POWERED UP, NO LED IS ILLUMINATED

- ground connection professional connected ?
- +12V power cable well connected ?
- remote cable professional connected ?
- fuses inserted and alright ?
- analyze voltage on the amplifier.

ALARM LED ILLUMINATES BLUE WHILE AMPLIFIER IS SOUNDLESS

- cinch cable alright and professional connected ?
- loudspeaker professional connected ?
- head unit alright ?

ALARM LED ILLUMINATES RED WHEN AMPLIFIER IS POWERED UP

- amplifier too hot ?
- short circuit at the loudspeaker output ?
- short circuit caused by loudspeaker cable with vehicle chassis (ground) ?
- input voltage too high (e.g. faulty lighting dynamo) ?

OVERHEATING (ALARM LED ILLUMINATES RED WHEN AMPLIFIER IS POWERED UP)

- impedance alright ?
- loudspeaker error ?
- adequate ventilation around the amplifier ?

! CAUTION !

After cooling down, the amplifier turns on automatically

ERROR IN AMPLIFIER FUSE

- ground professional connected ?
- loudspeaker impedance alright ?

! CAUTION !

Make sure when changing fuses to use the same value.

SOUND TOO LOW OR DISTORTED SOUND

- input level control "GAIN" is set to match the head unit ?
 - output level control of the head unit alright ?
 - loudspeaker error ?
 - loudspeaker cable checked ?
 - crossover frequencies have been properly set ?
- (Check head unit, amplifier, DSP, sound processor, equalizer, frequency bandpass filter...)

HIGH HISS OR ENGINE NOISE IN SPEAKER

- ground connection professional connected ?
- short circuit caused by loudspeaker cable with vehicle chassis ground ?
- cinch cable (RCA) and/or loudspeaker cable installed too close to the power connection cable ?
- cinch ground (RCA) of head unit alright ?

⚠ CAUTION ⚠

Please contact your specialist dealer if the amplifier still does not work even after the above troubleshooting list had been checked.

For warranty adjustment / repairs, the original invoice has to be presented!

Opening or disassembling the amplifier void warranty!